

The Park at Flat Rock

55 Highland Golf Dr.
Flat Rock, NC



The Park at Flat Rock is open from dawn to dusk year round. The 66-acre park has a flat, open green space and a 1.3 mile perimeter trail that you can walk or run.

The trails are a flat, all-season walkable surface that begin and end at the parking lot. Most of the trails are composed of a soft surface made of finely crushed, compacted rock and can handle flooding with minimal damage. There is a short section of interior trails made of asphalt. Visit Flat Rock Park.



For more information visit: flatrockparkfoundation.org

Carl Sandburg

National Historic Site

1800 Little River Road Flat Rock, NC

Carl Sandburg NHS is open 7 days a week, year round. Closed Thanksgiving, Christmas and New Year's Days. The park is located on 264 acres in western North Carolina. Hiking Trails include:

- Trout Pond Trail - .15 miles - Climbs Gently - Few Obstacles
- Entrance Trail - .25 miles - Climbs Moderately - Few Obstacles
- Little Glassy Trail - .30 miles - Few Hills - Some Obstacles
- Front Lake Trail - .40 - Climbs Gently - Few Obstacles
- Memminger Trail - .90 miles - Few Hills - Some Obstacles
- Glassy Mountain - 1.5 miles - Climbs Moderately - Some Obstacles



For more information visit: hikewnc.info/trailheads/carl-sandburg-home-national-historic-site

Take A Walk Try A Hike

Just A Stroll - There Are Several Places To Go



Rail Pen Gap Park

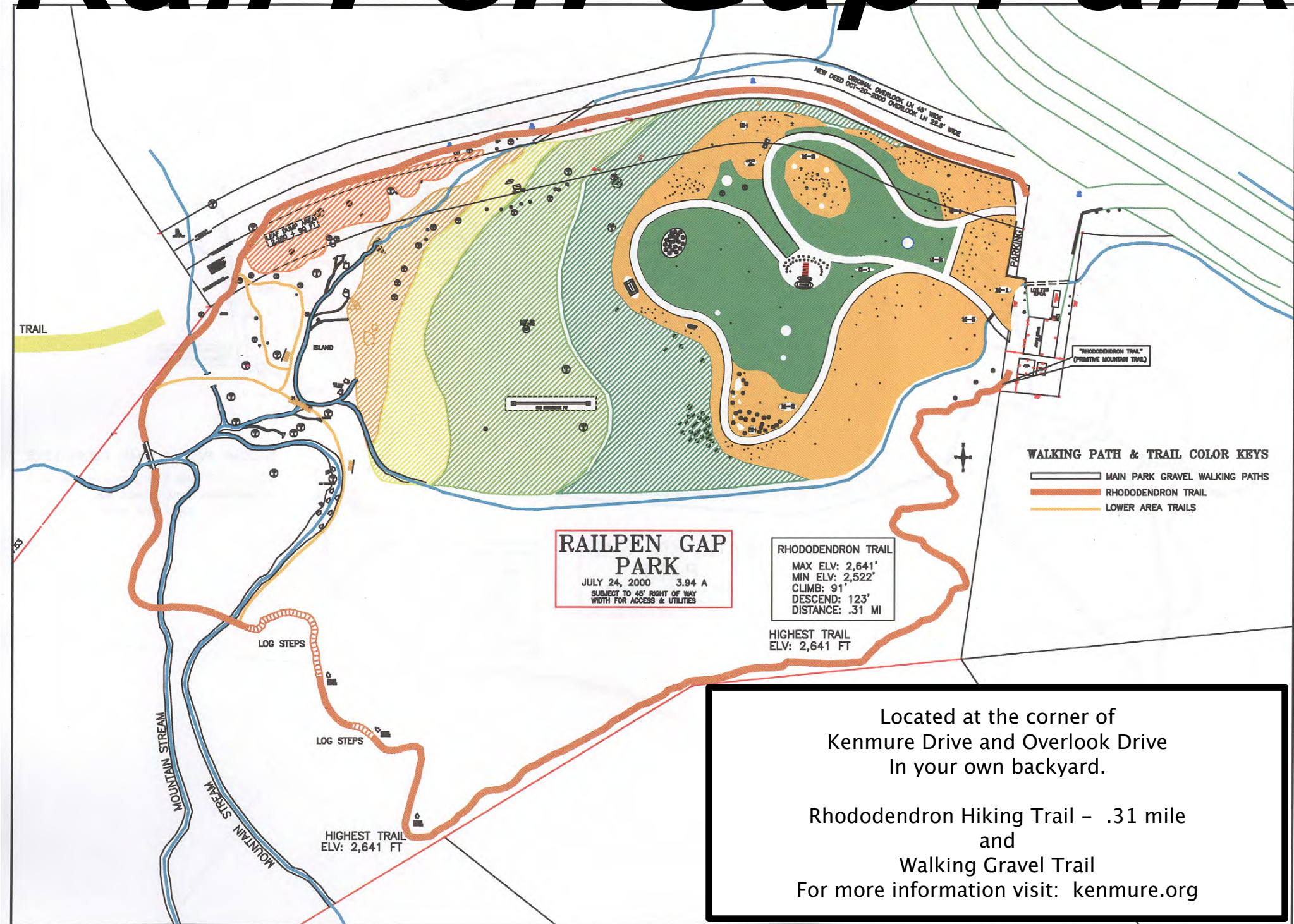

RAILPEN GAP PARK
JULY 24, 2000 3.94 A
SUBJECT TO 45' RIGHT OF WAY WIDTH FOR ACCESS & UTILITIES

RHODODENDRON TRAIL
MAX ELV: 2,641'
MIN ELV: 2,522'
CLIMB: 91'
DESCEND: 123'
DISTANCE: .31 MI

HIGHEST TRAIL ELV: 2,641 FT

WALKING PATH & TRAIL COLOR KEYS

- MAIN PARK GRAVEL WALKING PATHS
- RHODODENDRON TRAIL
- LOWER AREA TRAILS

Located at the corner of Kenmure Drive and Overlook Drive
In your own backyard.

Rhododendron Hiking Trail - .31 mile
and
Walking Gravel Trail

For more information visit: kenmure.org